

STRIP DIMENSION

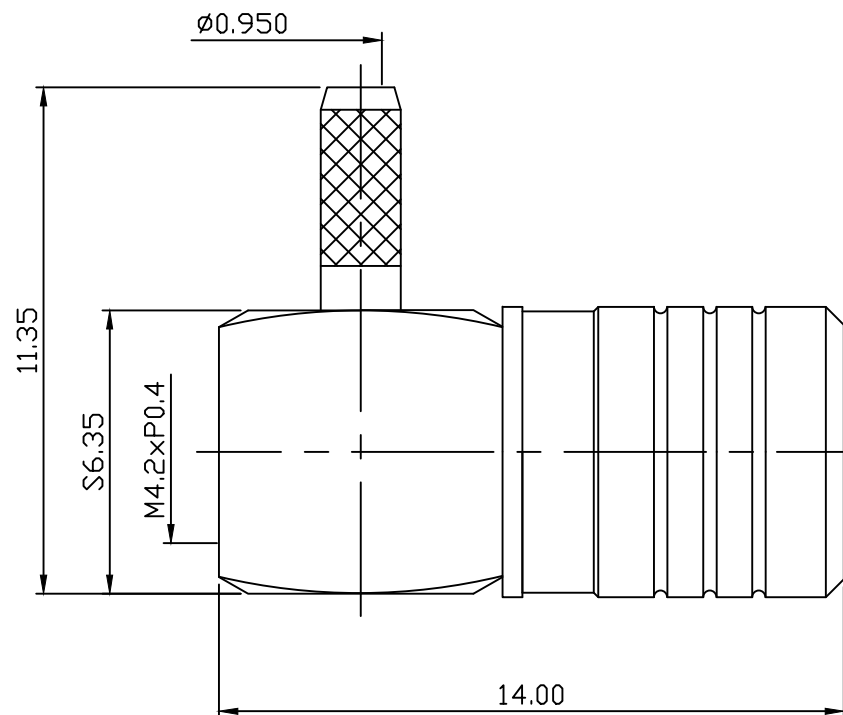

MATERIAL : BODY-BRASS
 NUT-BRASS
 SLEEVE-BRASS
 SHELL-BRASS
 INSULATOR-TEFLON
 CONTACT-BERYLLIUM COPPER
 SPRING WASHER-BERYLLIUM COPPER
 FURRULE-BRASS

FINISH : BODY-GOLD PLATING OVER NICKEL
 NUT-GOLD PLATING OVER NICKEL
 SLEEVE-GOLD PLATING OVER NICKEL
 SHELL-GOLD PLATING OVER NICKEL
 SPRING WASHER-GOLD PLATING OVER NICKEL
 FURRULE-GOLD PLATING OVER NICKEL
 CONTACT-GOLD PLATING OVER NICKEL

DIMENSIONS ARE IN MILLIMETERS TOLERANCE				C&C ELECTRONICS CONNECTORS INC	
· × ±0.5	ANGLE ±3°	SCALE 6:1	TITLE SMB RIGHT ANGLE PLUG CRIMP FOR RG _{178u} 196u		
· × × ±0.1		REV A-1			
· × × × ±0.05		DRAWN 潘曉臨	DATE 99.07.30	DRAWING NO 808-1108	
APPROVAL		DATE	FILE NO 808-0019		